

ARCHITECTURE
POWERED BY NATURE
TO EMPOWER PEOPLE

broekbakema





DSM MATERIALS CENTER - GELEEN

INTRODUCTION

With great pleasure we present you a short office portfolio of Broekbakema.

Besides our vision we explain 'who we are', 'what our values are' and 'how we collaborate'. Additionally, we proudly present some of our most recent projects.

Our portfolio consists of exciting projects: from small redesigns to complex new buildings and complete master plans. We are known for designing high standard environments for education and research and for transforming monuments; for our involved collaboration and our self-evident use of sustainability measures in our designs and for our extensive experience with an integral collaboration process.

We will gladly tell you more on our vision and approach in a personal conversation and wish you first of all much pleasure in reading.

Yours sincerely,

Erik van Eck and Aldo Vos
Directors Broekbakema



VISION

We believe in the power of nature. The power of nature as energy source, using the natural elements for the indoor climate and the power to create renewable materials. If we can design buildings based on nature, we are convinced to make people not only happier and more productive, but also more enthusiastic to collaborate with others. That's why our motto is:

“Architecture, powered by nature, to empower people”.



DSM MATERIALS CENTER - GELEEN



DSM MATERIALS CENTER - GELEEN



BROEKBAKEMA ARCHITECTURE, INTERIOR AND MASTERPLANNING

Our architectural office connects people and society in attractive architecture, by combining craftsmanship with sustainable innovation.

Four essential values form the base of our approach to our projects: co-creation, communities, sustainable innovation and craftsmanship.



**BNA GEBOUW VAN
HET JAAR 2011
WINNAAR**



GEBOUW X - WINDESHEIM



GEBOUW X - WINDESHEIM



ATRIUM, GEBOUW X - WINDESHEIM



SUSTAINABLE INNOVATION

Back to the essence of architecture. We consider it our job to make architecture that has a lasting impact on society. Our designs are therefore based on the essence of architecture, a 'form follows climate' approach. A comfortable building is accomplished by its shape, its orientation, through architectural solutions. In addition, we make maximum use of natural resources. In many cases the use of technology is no longer a necessity. Technology we do use as complementary applications are always based on green, renewable energy.

This concept was realized in the Energy Academy Europe in Groningen. We can proudly state it is the most sustainable education building in The Netherlands; with its BREEAM Outstanding score it is the only education building in The Netherlands to achieve this high level of sustainability. The Energy Academy Groningen won the International BREEAM Award 2017 in the category 'Mixed Use & Other'. For a more in-depth vision I refer you to our website:

<https://www.broekbakema.nl/en/vision/>

ENERGY ACADEMY EUROPE - GRONINGEN

THE MOST SUSTAINABLE EDUCATION BUILDING IN THE NETHERLANDS



ATRIUM, ENERGY ACADEMY EUROPE - GRONINGEN



Linnaeusborg



GREEN LANDMARK, OCE HEADQUARTERS - VENLO

CO-CREATION

Good and appealing buildings are made together. Co-creation, close cooperation with all parties concerned, is self-evident to us. A well-structured creative process, together with the client and the users, underlies this.

From the very first start, we work together with all disciplines on the design. In a project team in which dialogue is most important, in informal meetings with the neighbouring residents to decide on colours for the façade, or by working together in a shared 3D model.

Interaction, clarity and the exchange of knowledge ensure that the project is placed literally and figuratively firmly in society.



ATRIUM OCE HEADQUARTERS - VENLO





COMMUNITIES

Our buildings connect people and create societies. This we achieve by shaping planned and spontaneous meetings in our designs. By being responsive to changes and current issues in society and to think of solutions, we want to encourage the development of communities.

And of course by creating well-functioning buildings that are appealing and that the users and their environment can be proud of.



WOODEN SCHOOL, BREDE SCHOOL - LISSE

CRAFTSMANSHIP

Quality comes first

We know how things work. We are most familiar with the requirements for a good building, we know all about materials and how to properly use them and we know how to maintain a building. From start to finish we are involved in our projects in an enthusiastic way and manage the process efficiently within time and budget.

Our business management is organised at professional level. We value high quality: of our buildings, but also of our processes. Therefore we work in accordance with an ISO 9001 certified quality assurance system. This means that all processes within the company are documented and complied with. That is why we even have an independent quality coordinator.

Also externally we work on quality control. By means of our role in the BNA we actively contribute to the development of the sector. Our designs are continuously monitored on budget, time, quality and ambition to prevent surprises from occurring. We have a proactive approach and work in close collaboration with financial experts from the commencement of the design.



TEMPORARY RESTAURANT - GELEEN

EXPERTISES

We are proud of the fact that our clients identify themselves with our architecture and working methods.

Our portfolio consists of exciting projects: from small redesigns to complex new buildings and complete master plans. We are known for designing high standard environments for education and research and for transforming monuments; for our involved collaboration and our self-evident use of sustainability measures in our designs and for our extensive experience with an integral collaboration process.

MASTERPLANS

Connecting, futureproof, flexible and sustainable: those are values that have formed the base of all our masterplans. For over 20 years we have been working on various masterplans in which we aim for a high-quality environment with an optimal relation between the various functions, with a particular attention to meetings and communities.

MASTERPLAN CHEMELOT CAMPUS - GELEEN





ENTRANCE BUILDING CHEMELOT CAMPUS - GELEEN



EDUCATION

Learning together in open, flexible and inspiring spaces: Broekbakema places a high value on designing education buildings.

We make education buildings on all scales that are adjusted to the needs of its users. We have great experience ranging from university structures to child daycare centers and from more traditional class layouts to more contemporary and flexible learning landscapes. This way we are able to design the ideal learning environment for each user under any circumstance.



PASSIVE SCHOOL GSG LEO VROMAN - GOUDA



DSM MATERIALS CENTER - GELEEN

LABORATORIES

We have been experts in designing and prescribing high-quality and modern spaces for innovative research in all forms for years.

From conceptual design to technical specifications and execution, Broekbakema has designed many laboratories and workshops for research and development. This allows us to design the right labs custom-tailored for our clients.

Van conceptniveau tot bestek en uitvoering werkt Broekbakema al jaren aan diverse laboratoria en werkplaatsen voor onderzoek en ontwikkeling. Zo ontwerpen we de juiste labs op maat gesneden voor onze klanten.





RESIDENTIAL FARM NOOITGEDACHT - VLAARDINGEN

HEALTHCARE

We believe careful design is needed where care is being given. Therefore we design healthcare institutions as well as elderly residences with great attention to detail in both small and large sizes.

That is why we also like to contribute to making existing healthcare facilities and residences 'senior-friendly'.





RESIDENTIAL

We enjoy designing spaces to live in, grow up and get old. From villa's to apartments and from more traditional lifestyles to more innovative ones.



ELDERLY APARTMENTS - DOORN



TRANSFORMATION DIKHUIDENVLEUGEL BLIJDORP - ROTTERDAM

TRANSFORMATION

The transformation of buildings fits us like a glove. Whether it is modifying interiors or renovating stylish young monument: we happily work together with you to design any transformation at any scale.

For instance, we are readily at work to protect, renovate and transform historic structures. In these processes we collaborate closely with relevant committees and experts such as historians and sociologists in order to restore young monuments to their former glory or transform them to new functions.



TRANSFORMATIE WEES- EN OUDELIEDENHUISTO ELDERLY APARTMENTS - LEIDEN



INTERIOR

Formal, cosy, cool, high-end, residential: each client or organisation requires its own look for their interiors. From layout to detailing we shape this characteristic identity.

By deepening ourselves in the identity of the client and the desired look from the organisation, each project contains a unique combination of demands and wishes for our interiors. We make sure that the interior facilitates the working method of an organisation and reflects the identity of its users. Our approach is the same in all cases; the unique user and functionality are central. By means of this approach we can design the ideal environment for each project, from office to retail, education and research.





OFFICE CONCEPTS & WORKPLACE ANALYTICS

CUSTOM-TAILORED DESIGN BY UNIQUE ANALYSIS METHOD

To design well we do not need to know what the user thinks of his/her workspace, but how he/she works. Finding this is generally time consuming and costly, resulting in the fact that often only a sounding board is asked. However, Workplace Analytics (WPA) is a new, fast and effective method to determine the needs of all workers. An excellent base for a successful building design. For Broekbakema this is reason enough to form a partnership with Innvire, who developed WPA.

Currently we are successfully implementing this method in our projects, resulting in an individual tailor-made suit for each organisation. This is translated into a contemporary workspace, a suit in which users can recognise themselves and be proud of.



BIM

Integral design from design to execution. From the beginning of each project we work collaboratively with all disciplines from the building sector in a single 3D model, the so-called BIM model.

This allows for parties to communicate faster, more efficiently and more often during the design process. This leads to a better building for the user and lower failure costs during execution.

From 2014 onward simBolic has been executing BIM-management activities from Broekbakema. simBolic is an independent organisation founded from our office. The BIM expertise from our office is independently continued in this organisation.

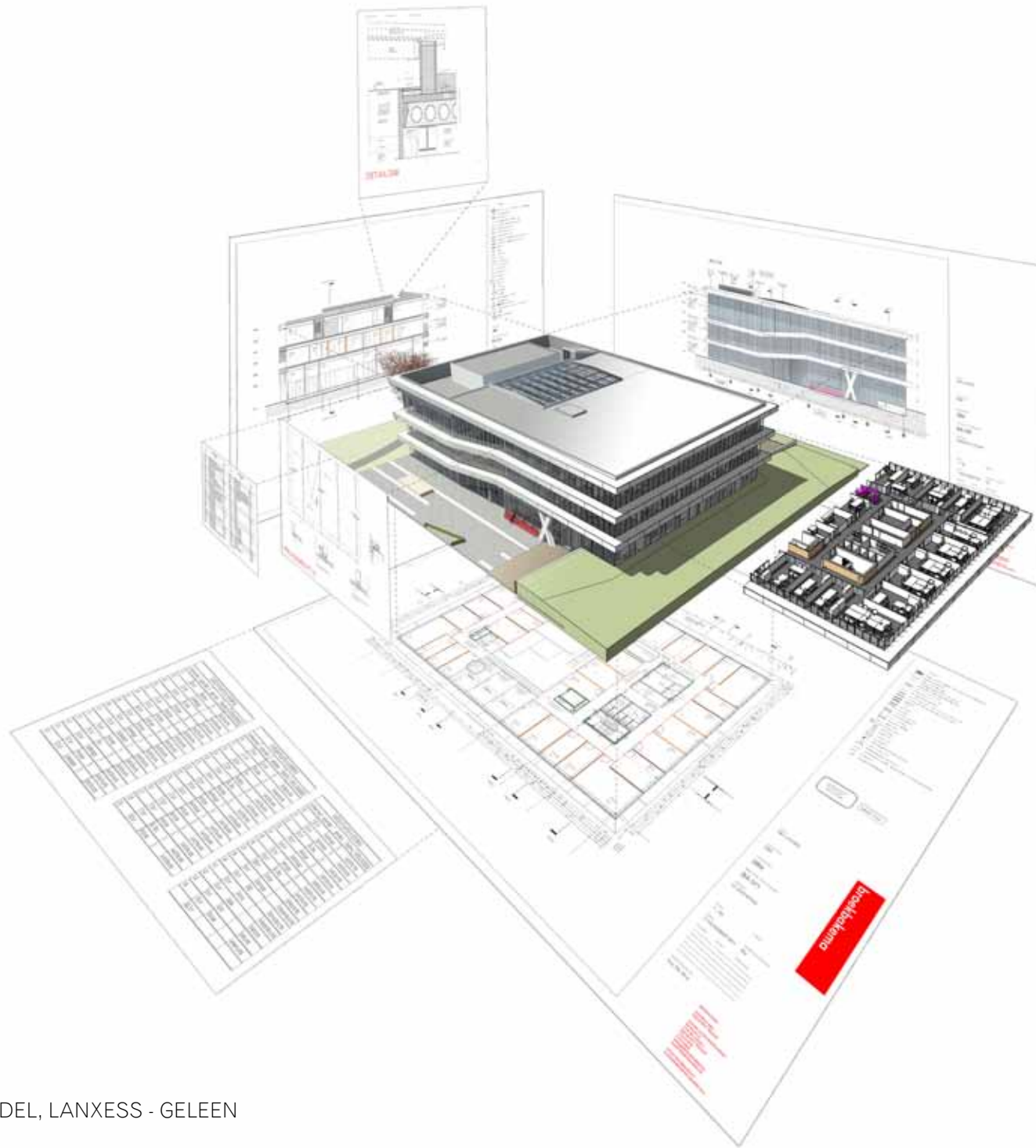



GEBOUW X - WINDESHEIM



SYNTHON LAB AND OFFICES - NIJMEGEN

REFERENCES

"We were not only looking for a good design, but mainly for a good designer."

Hans Valent

Windesheim University of Applied Sciences

"Broekbakema and Synthon have been collaborating for years now. And that is not without reason. Motivated and content-wise strong people work there for and with us to get the most out of our building projects."

Koen Kodde

Synthon



VAN NELLE FABRIEK - ROTTERDAM

OFFICE

Our office was founded in 1910 and is located in the renown Van Nelle Factory in Rotterdam, designed by the founders of our office Brinkman and Van der Vlugt.

Also today we are actively working on the preservation and renovation of this UNESCO World Heritage as coordinating architect. At this beautiful location we continue to work in an open and respectful manner on interesting projects.

"Good buildings are made together."



BROEKBAKEMA LAB

Broekbakema believes in the positive power of architecture. We look forward, determine social developments and put issues in the sector in daylight. By doing research by design, with innovative concepts and critical opinions as result.

This in order to make a relevant contribution to the architectural and social ideas of today and tomorrow.

